

**DC306L-AF Front and Rear Dual-Lens  
Digital Camera Auto Focus 16X Zoom  
Vlogging Camera for Teens - White**



## **Preface**

Thanks for purchasing our digital camera. Please read the user manual prior to using the camera and keep the manual in good manner for future use.

Instructions stated in this user manual are the latest information at the time when the manual was made. Display or illustration used in the manual are proposed to show camera operation directly and comprehensively. Since the products can be from different batches of production and development, the display or illustration might be slightly different from what you have in hand.

## **Instruction**

1. Insert the battery and turn on the camera.
2. Insert and format memory card.
3. Take photo/video.
4. Connect and transfer files to the computer.

*Attention:* Please format the memory card through this camera if it is new or was used by another camera. Please backup the data by floppy disk, hard-disk before format.

## **Instructions of memory card**

- Please format the memory card if it is new or has unidentified data or photos made by other cameras
- Please switch off power before inserting or remove the memory card
- Performance of memory cards can be weakened after repeated use. Please replace it with a new memory card if the performance is down
- As a precision electronic unit, do not fold, drop or squeeze the memory card
- Do not put the memory card at high electric field or magnetic environment, such as near speaker or TV receiver
- Do not use or put the memory card on superheated or super-cooling environment
- Please keep the memory card clean, and keep it away from any liquid
- Use a soft fabric to clean the memory card if it has contact with liquid
- Please put the memory card in the card sleeve when not in use
- Please be aware of that it is normal when the memory card bewarming after long-time use
- Do not use a memory card which was used by other digital cameras. Please format it with this camera before using it
- Do not use memory card which was formatted by other digital video or card reader

- Data can be damaged if the memory card suffers the situations as below:  
Incorrect use / Switch off power or remove the memory card when recording, deleting (formatting) or reading the card
- Recommend to copy important data by other medias, such as floppy disk, hard-disk

### **Camera Maintenance**

Keep the camera in a dry and dark place when not in use, and get the battery out.

- Wear the wrist strap when using the camera to prevent falling
- Use proper protective casing to prevent lens and screen scratch
- To clean the lens surface, please blow dust away then wipe the lens lightly with fabric or paper special for optical devices. Lens cleanser can be used if necessary. Do not use organic solvent to clean the camera
- Do not touch the lens with your finger

### **Function & Feature**

The camera has multiple functions and features:

- 4K Videos
- 48 Megapixels Photos
- Selfie lens
- 16X powerful zoom
- Auto focus

## Appearance

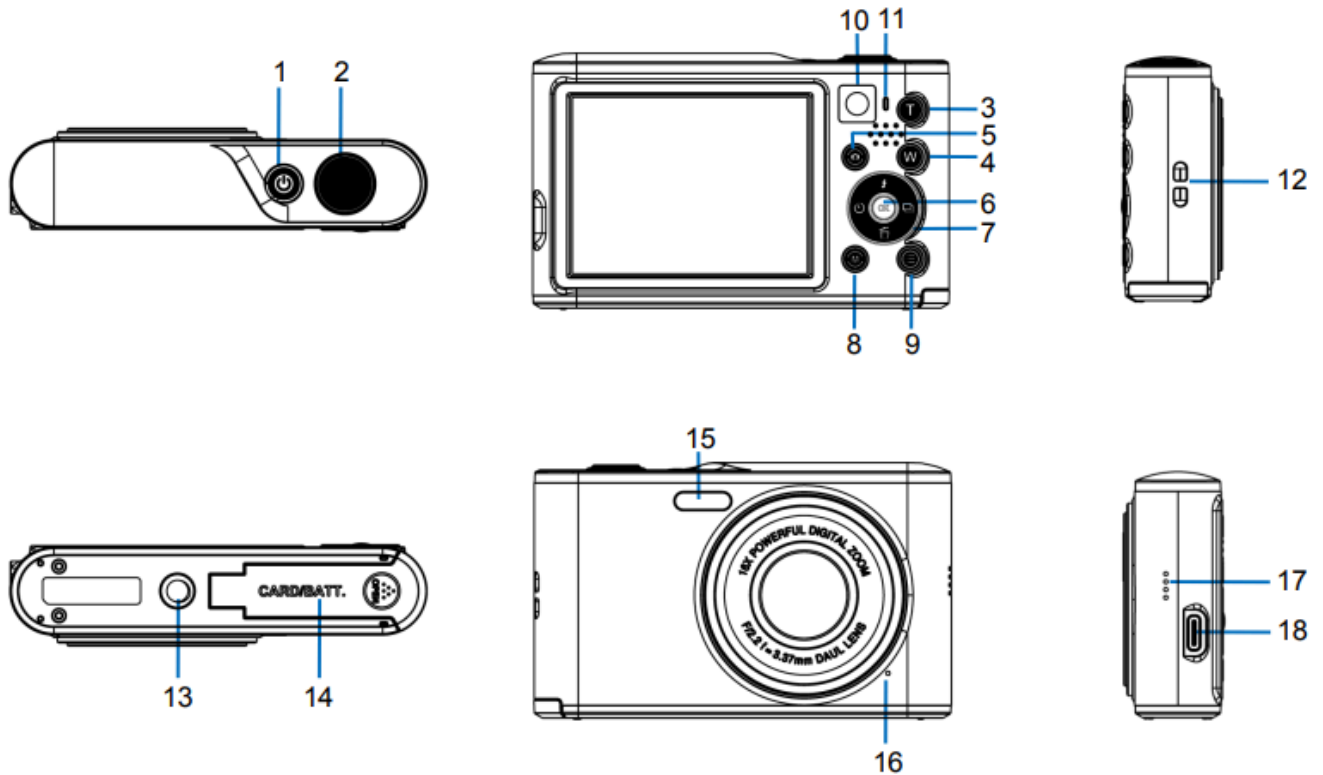

1. POWER button - ON/OFF
2. Shooting button - Photo shooting, video recording
3. T button - Zoom in / Turn the volume up (Playback mode)
4. W button - Zoom out / Turn the volume down (Playback mode)
5. Selfie lens switch
6. OK button - Pause/Continue playing (when playing a video), Confirm (other circumstances)
7. Direction key - Up/Down (UP: Turn on/off the fill light (video/photo mode), Menu selection; DOWN: Delete key (in photo mode, press this button to quickly delete the photo) (in video mode, press this button to quickly delete the video after recording a video); Menu selection  
Direction key - Left/right - Left: Photo timer shortcut button under photo mode (press this button to quickly set the timer photo countdown time to 2 seconds, 5 seconds or 10 seconds); Menu selection. Right: Continuous shooting short cuts under photo mode (press this key to quickly set the mode to continuous shooting); Menu selection.
8. MODE - Switch the working mode (photo/video/playback/setting)
9. MENU - Enter/exit the menu

10. Selfie lens
11. Indicator light (Power & Charging) - The blue light is working status indicator light. The red light is a charging indicator light; the red light will be on when connected with a charger. The red light will go off when the battery is full.
12. Hang buckle - Connecting the camera strap
13. Tripod interface
14. Battery compartment cover - Battery and TF card location
15. LED light
16. Microphone
17. Speaker holes
18. Type C port

### How to insert and remove the battery

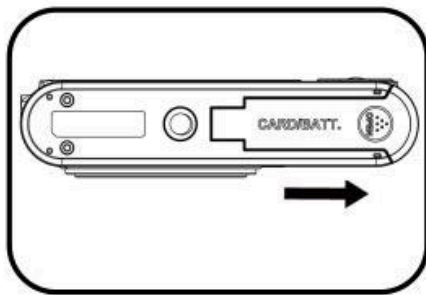

1.

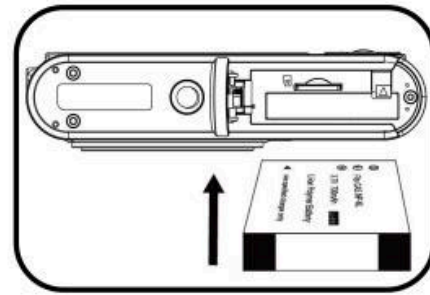

2.

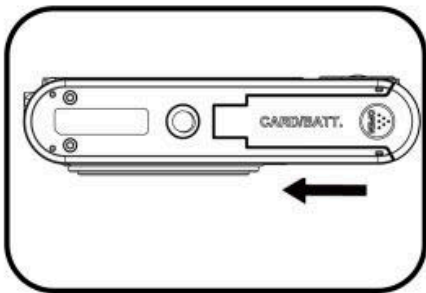

3.

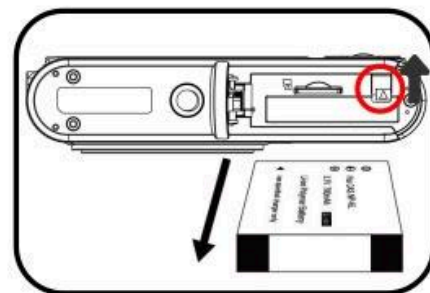

4.

1. Open the battery cover
2. Insert the end with electrical contacts until it locked into place
3. Close the battery cover
4. Please push the battery lock lever to remove the battery

## How to charge the camera

- Please use the Type C cable and charger included in the package to charge the camera
- When the camera indicator light is red, it means the camera is charging
- When the camera light goes out, it means the camera is fully charged

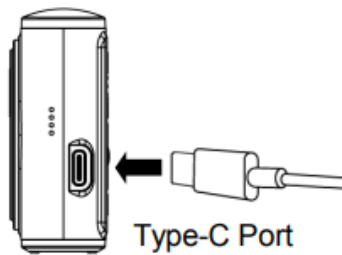

*Note:* If the charging light flickers slightly, it indicates that the battery is not installed or reversed. Please check if the battery is installed correctly.

## How to insert and remove TF card

- Open the battery cover
- As shown by the illustration, face the card's metal contacts side toward you and insert it until it locks in place
- Close the battery cover

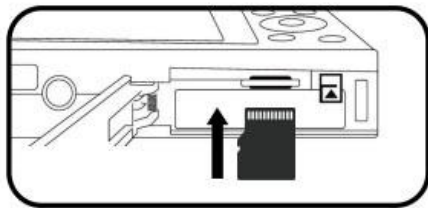

Metal contacts  
side

### *Attention:*

1. When you use the Micro SD card for the first time, please format it in the camera.
2. Please keep pressing the card until the lock lever locks it. When the card is locked, you will hear a "click" sound.

## **Switch on/off**

Long press the power button to switch on or switch off the camera.

Turn on Auto-off function, if no operation is done in the time beyond auto off time, the camera will be switched off automatically for energy saving.

## **Switch-over mode**

Press MODE key to switch photo, video, playback and system setting modes.

## **Video/Photo**

After the camera is turned on, press the shooting button to take photos.

Press mode button to enter video mode, press shooting button to start recording a video and press the button again to finish the video.

## **Auto focus photograph**

In the photo mode, press the shutter button half way down to focus to keep the camera still. The camera will focus automatically at this time. When you see the focus frame on the screen turns from yellow to green, it means that the focus is completed, and then press the shoot button fully to take the current photo. (Keep the camera still during this process and do not release the shooting button).

## **Date & Time Setting**

Under photo mode, press mode key three times to open the system menu setting, press right button to select "Set Date" setting. Under "Date&Time" setting, you can choose that the date stamp is on or off.

## **Video/Photo Mode**

The camera enters into photo mode automatically after switching on, press shooting button to take photos. Press mode key to enter video mode, press shooting button to start recording a video, press it again to stop recording. Press mode key to switch modes, press T or W key to have digital zoom.

## Selfie Mode Switch

1. Please Press the selfie lens switch button
2. Press the shutter button to take a photo or video (In selfie mode, the camera doesn't support auto focus).

## Display information under Photo mode

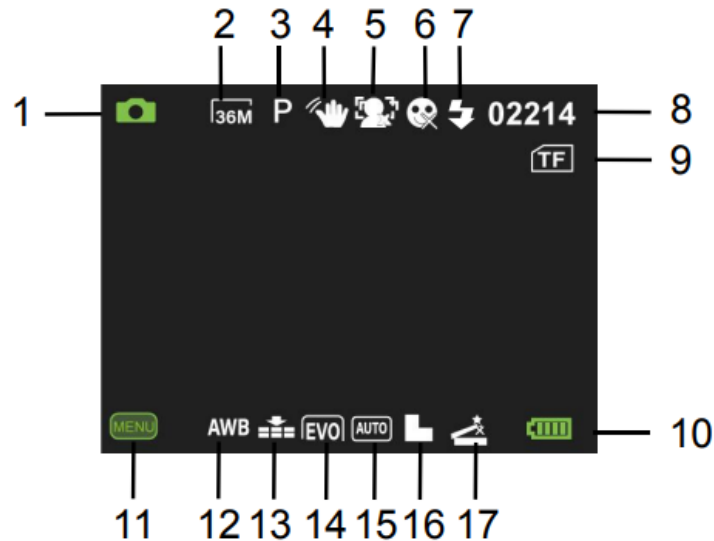

1. Photo mode - Press shooting button to take photos
2. Resolution - Current resolution
3. P - Mode
4. Anti shake - Prevent camera shake from affecting image clarity
5. Face detection - Face detecting function
6. Smile detection - Smile detecting function
7. Flash - Off/Automatic
8. Available number of photos - Space for photo shooting
9. TF card - Current TF card
10. Power volume - Current battery status
11. Menu - Menu button
12. AWB - Automatic white balance
13. Image quality - Quality of current image
14. Exposure - Current exposure
15. ISO - Automatically adjust the ISO value
16. Sharpness - Current sharpness
17. Effect - Current effect



## Display information under video mode

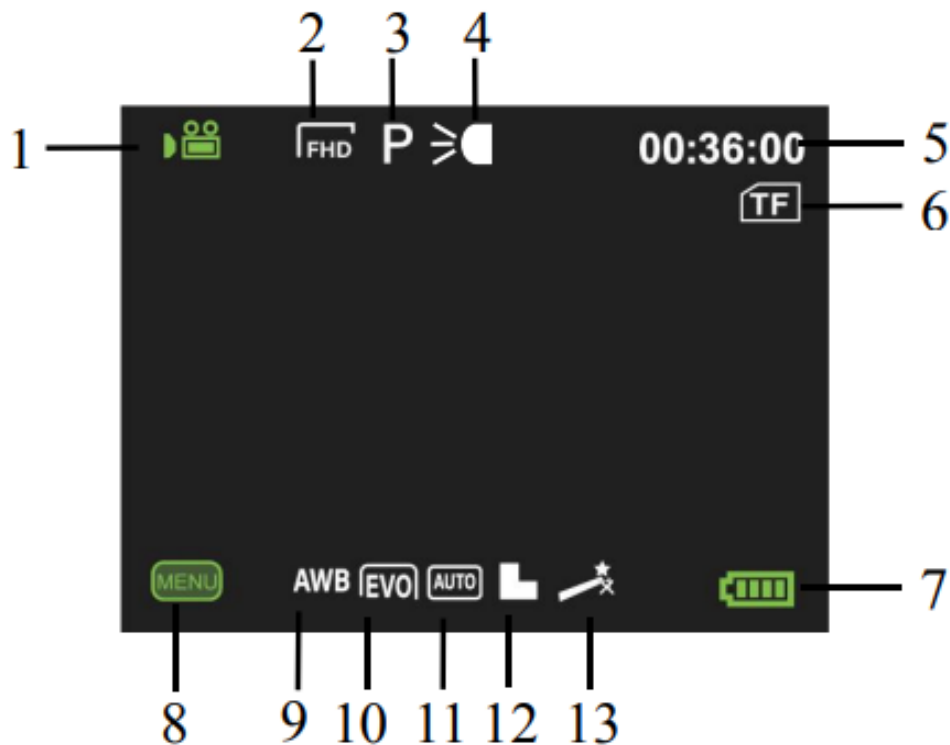

1. Video mode - Press shooting button to start recording
2. Resolution - Video resolution
3. P - Mode
4. Flash - Off/Always on
5. Recording time - The current available recording time
6. TF card - Current TF card
7. Power volume - Current battery status
8. Menu - Menu button
9. AWB - Automatic white balance
10. Exposure - Current exposure
11. ISO - Automatically adjust the ISO value
12. Sharpness - Current sharpness
13. Effect - Current effect

## **System menu settings**

Under photo mode, press the Mode key three times to open the system menu, press left/right button or Up/Down key to select the submenu. Then press OK to save the setting, or press the MENU button to cancel the setting.

## **Video and Photo Menu setting**

Under video/photo mode, press the MENU button to enter the video/photo menu setting. The methods of video and photo menu setting are as same as that of System menu setting.

*Attention:* 1. Please hold the camera stable when photo shooting. To take photos with the best quality, it is better to put the camera on a support like a tripod.  
2. BUSY light is on after use of shutter for photo, do not move the camera at the moment until the BUSY light is off, to ensure clear photos.

## **Playback**

Under photo mode, press Mode button twice to enter playback interface, press MENU key to playback menu settings, video files can be deleted or protected, and photo files can be deleted, protected, rotated, and played as a slideshow. Press Up/Down or left/right button to select the menu, press OK to get in the sub-menu. After setting is complete, press OK to save the setting, or press MENU button to cancel the setting.  
Note: Selected menu will be highlighted after selection.

## **Download photo/video to computer**

Connect the camera with the computer, skip to "My Computer" to check the new removable disk, the photo or video made by the camera are saved under DCIM, and the user can copy the data from this file to the computer.

*Attention:* Do not disconnect the camera with the computer when downloading files. To prevent data loss, do not insert or remove the memory card in the camera when USB connects with.

## Specification

- Movie Size - 4K ULTRA HD; 2.7K-30FPS; FULL HD-30FPS; HD-30FPS; VGA-30FPS
- Resolution ratio of image: 48M(8000×6000); 44M(7600×5800); 36M(7936×4480 HD); 24M(5600×4200); 20M(5200×3900); 16M(4608×3456); 12M(4000×3000); 10M(3648×2736); 7M-Wide(3648×2048 HD); 5M(2592×1944); 3M(2048× 1536); 2M-Wide(1920×1080HD)
- Memory card - Supports TF memory card and MMC card (4GB to 256GB)
- File format - JPG, AVI
- Self-timer - 2s/5s/10s
- Digital zoom - 16X
- White balance - Auto/Daylight/Cloudy/Fluorescent/Tungsten
- Exposure compensation - -3.0 / +3.0
- Screen - IPS display screen
- Power - Rechargeable lithium battery
- Menu language - Multi-Languages
- Focal distance -  $f=3.37\text{mm}$
- Aperture - F/2.2
- Auto Off - 1 minutes/3 minutes/5 minutes/No shutdown
- Operating system requirements - Win7/Win8/Win 10/Win 11

*Attention:* Product specification is the latest information at the time when this use manual is made. No further notice will be made for any variation. Specific operating methods are subject to the real camera that you purchased.

## Questions And Answers

- The camera fails to work after battery placement
  - The power may be too low, so a new battery is needed.
  - Plastic package of the battery is not removed.
  - Battery may be placed reversely. Ensure correct placement of battery.
- Shutter is not working to take videos or photos
  - Memory card may be full. Please try again with another memory card.
- Unsharp photos
  - May be caused by shaking hands. Please keep the camera stable or use other supports like tripod. Do not shake the camera when photo shooting.

- Dark photos or videos
  - Shooting environment may be too dark. Please make the shooting at a bright place, or use light to brighten the shooting place.
  
- Auto Off
  - Battery may have too low power. Please change to a new battery.
  - To save energy, the camera will be turned off automatically if not in use for 1 minute, 3 minutes or 5 minutes.
  
- The video camera freezes or shows blurred screen
  - TF card format error, please format the TF card within the video camera or on the computer before use it. Or please contact the seller.

